

NEW RELEASE!

CE8000 SERIES

CE8000-40 / 60 / 130

Enhanced basic specifications and excellent cost-effectiveness



New Control Panel

- Touch Screen AND Mechanical Keys
- New Menu Structure
- Integrated Firmware Updates

Wireless LAN

Wireless LAN connection option improves flexibility of installation locations

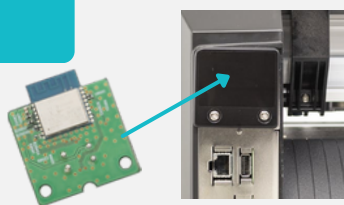

New ARMS 9.0

(Advanced Registration Mark System) for multiple print & cut applications

New Blade holder/Mount

New Holder design makes it easier to change tools and blade position by sliding the stopper forward and back



Redesigned Tool Holder

Tool compartment now has a magnetic base making it easy to move location and allows option to remove if needed



New Basket

CE8000 SERIES

CE7000 / CE8000 Differences



New Control Panel

NEW TOUCH PANEL with MECHANICAL KEYS

This feature gives users more flexibility with its Blind Touch Operation enabling the operator to continually keep eyes on media while feeding

NEW MENU STRUCTURE

Revisions to the menu are more intuitive and efficient utilizing the new touch screen feature with icons that allow easier operation.



Blind Touch Operation

Intuitive operability accelerates workflow

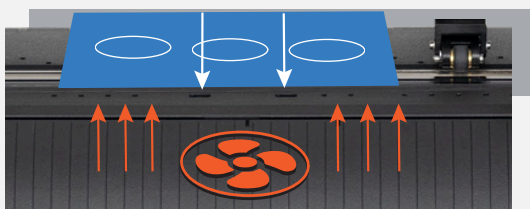

New Media Assist

The CE8000 internal fan automatically turns on as sensor recognizes media to support feeding

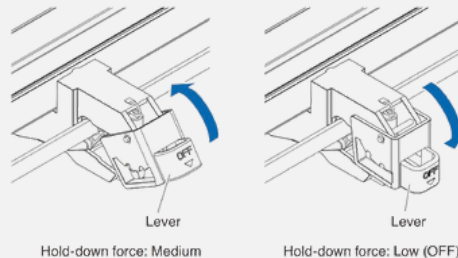

New Push-roller Design

The CE8000 series features adjustable hold-down force with fixed force at the ends (5.5kg) and switchable centre rollers (3.2kg), higher force than that of CE7000



New Blade Holder Design

PHP33-CB09N/15N exterior design has changed to match the more refined styling of the CE8000.

Revised Accessories

Accessories removed from the CE8000:

- Blade Loupe
- Fibre-tip Pen / Holder
- USB Cable

Optional Accessories:

- Media Basket
- Carrier Sheet Table
- Blade Loupe
- Fibre-tip Pen / Holder
- Roll Media Tray
- USB Cable

Easy Firmware Updates

- Check for New Firmware using Software Download /Update via Wireless LAN or USB
- Update New Firmware using a thumb drive when operating without network connection